

Index No	Part No	Description	Qty.	Index No	Part No	Description	Qty.
<b>A</b>	<b>8940169993</b>	<b>VALVE BLOCK COMPLETE</b>	1	02		O-ring	1
	10	Backhead	1	09	8950220489	Rubber Cushon	1
<b>A1</b>	<b>8940169994</b>	<b>THROTTLE VALVE KIT</b>	1	10	8950220490	Rear Valve Block	1
	03	Throttle Valve Seat (Incl. part #3-1)	1	11	8950220491	Piston	1
	05	Spring	1	12		Cylinder	1
	06	Valve Cap Set (Inc.part #2)	1	15	8950250445	Needle driver	1
	21	O-Ring (P3)	1	16	8951011498	Needle 3mmx120 (set of 12pcs)	1
<b>A2</b>	<b>8940169995</b>	<b>LEVER KIT</b>	1	17	8951011511	Needle Holder	1
	07	Lever	1	18	8950250446	Spring	1
	08	Spring Pin (3*24)	1	19	8950200613	Needle Tube	1
<b>B</b>	<b>8940169996</b>	<b>TUNE UP KIT</b>	1				
	05	Spring	1				
	08	Spring Pin (3*24)	1				
	09	8950220489	1				
	13	O-Ring (P24)	2				
	21	O-Ring (P3)	1				

	8940169840	Operator's Manual
	8940168387	EC Declaration
	6159948780	Safety instructions
	8950900061	Warning label

**Recommended accessories**

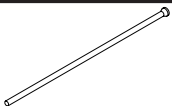

Needle 3mmx120 (set of 12pcs)

8951011498